

Item No.	TSP0000053D	Date	01.01.2017
		Revision	00
Description	M18, Inductive , DC 3-Wire with Cable / Connector termination	Page	1 of 4

**M18x1 Flush - Cable Type**

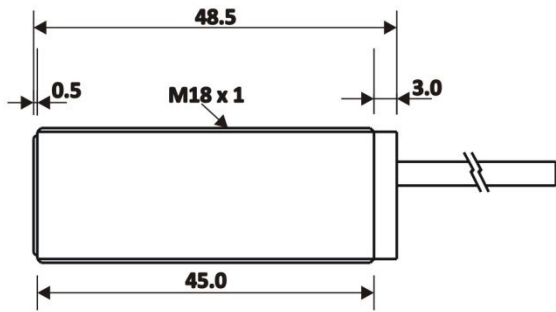

**M18x1 Non Flush - Cable Type**

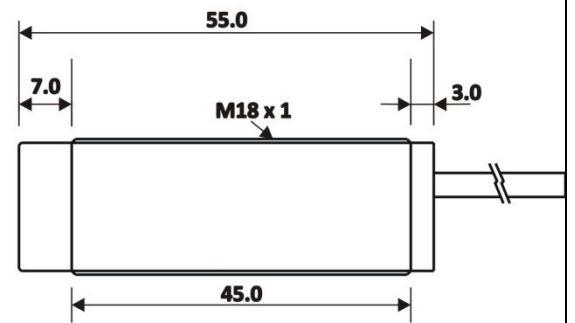

**M18x1 Flush - Connector Type**

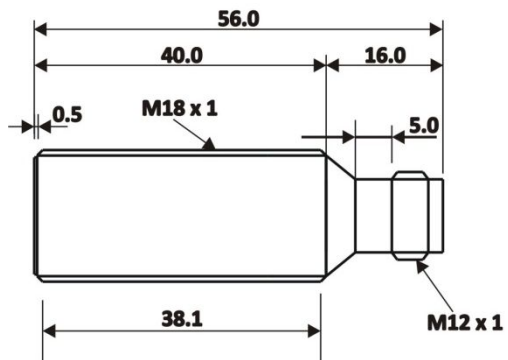

**M18x1 Non Flush - Connector Type**

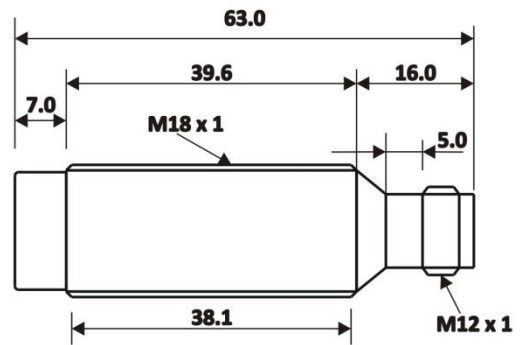

All dimensions are in mm.



Specifications are subject to change without notice.

Item No.	TSP0000053D	Date	01.01.2017
		Revision	00
Description	M18, Inductive , DC 3-Wire with Cable / Connector termination	Page	2 of 4

**Table-1**

**M18x1 DC 3 WIRE**

O/P Type	O/P Logic	Mounting	Sensing Distance(Sn)	Termination Type	Katlax Article No.
PNP	NO	FLUSH	5 mm	CABLE	IBF05-18B4-POW02
PNP	NO	NON FLUSH	8 mm	CABLE	IBN08-18B4-POW02
PNP	NC	FLUSH	5 mm	CABLE	IBF05-18B4-PCW02
PNP	NC	NON FLUSH	8 mm	CABLE	IBN08-18B4-PCW02
NPN	NO	FLUSH	5 mm	CABLE	IBF05-18B4-NOW02
NPN	NO	NON FLUSH	8 mm	CABLE	IBN08-18B4-NOW02
NPN	NC	FLUSH	5 mm	CABLE	IBF05-18B4-NCW02
NPN	NC	NON FLUSH	8 mm	CABLE	IBN08-18B4-NCW02
PNP	NO	FLUSH	5 mm	CONNECTOR	IBF05-18B5-POC12
PNP	NO	NON FLUSH	8 mm	CONNECTOR	IBN08-18B5-POC12
PNP	NC	FLUSH	5 mm	CONNECTOR	IBF05-18B5-PCC12
PNP	NC	NON FLUSH	8 mm	CONNECTOR	IBN08-18B5-PCC12
NPN	NO	FLUSH	5 mm	CONNECTOR	IBF05-18B5-NOC12
NPN	NO	NON FLUSH	8 mm	CONNECTOR	IBN08-18B5-NOC12
NPN	NC	FLUSH	5 mm	CONNECTOR	IBF05-18B5-NCC12
NPN	NC	NON FLUSH	8 mm	CONNECTOR	IBN08-18B5-NCC12



Specifications are subject to change without notice.

Item No.	TSP0000053D	Date	01.01.2017
		Revision	00
Description	M18, Inductive , DC 3-Wire with Cable / Connector termination	Page	3 of 4

**Table-2**

**TECHNICAL SPECIFICATIONS**

<b>Operating Voltage</b>	10-30 VDC
<b>Sensing Distance (Sn)</b>	5.0 mm - Flush
	8.0 mm - Non flush
<b>Hysteresis</b>	3-15% of Sn
<b>Standard target</b>	(18x18x1)mm Fe/St-37
<b>Correction factor</b>	Mild Steel                      1.00
	Stainless steel                0.80
	Brass                                0.50
	Aluminum                        0.45
	Copper                             0.40
<b>Ripple</b>	< 15%
<b>Voltage Drop</b>	< 1.5V DC
<b>No Load Current</b>	< 15 mA
<b>Max. Load Current</b>	200 mA
<b>Switching Frequency</b>	1.0 kHz - Flush
	800 Hz - Non Flush
<b>Reverse Polarity Protection</b>	YES
<b>Short Circuit Protection</b>	YES (Latch Type)
<b>Housing Material</b>	Brass(Ni Plated)
<b>Sensing Face Material</b>	P.B.T.
<b>Termination</b>	Cable (3 x 0.25 sqmm.) , 2 mtr
	M12 Male Connector
<b>Temperature Range</b>	-25°C....75°C
<b>Environmental Protection</b>	IP67



Specifications are subject to change without notice.

Item No.	TSP0000053D	Date	01.01.2017
		Revision	00
Description	M18, Inductive , DC 3-Wire with Cable / Connector termination	Page	4 of 4

## PNP Cable type



## NPN Cable type



## Connector type

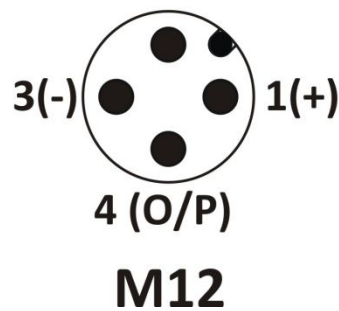

Specifications are subject to change without notice.